

CLUTCH RELEASE CYLINDER ASSY (From July, 2003) OVERHAUL

42027-05

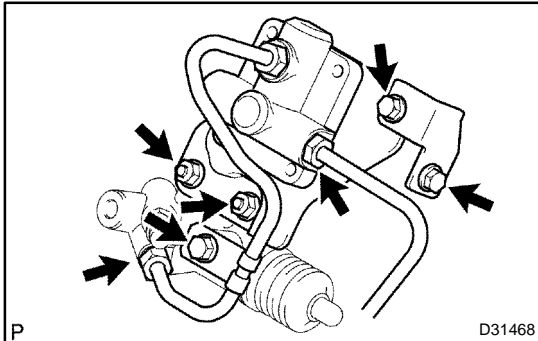

1. DISCONNECT CLUTCH RELEASE CYLINDER TO FLEXIBLE HOSE TUBE

- (a) Remove the bolt and separate the tube clamp bracket.
- (b) Using SST, disconnect the 2 flexible hose tubes.
SST 09023-00101

HINT:

Use a container to catch the fluid.

2. REMOVE CLUTCH ACCUMULATOR ASSY

- (a) Remove the 2 bolts and flexible hose bracket No.2.
- (b) Remove the 2 nuts and the clutch accumulator assy.

3. REMOVE CLUTCH RELEASE CYLINDER ASSY

- (a) Remove the 2 bolts and clutch release cylinder assy.

4. REMOVE CLUTCH RELEASE CYLINDER KIT

- (a) Remove the boot from the cylinder body.
- (b) Remove the push rod from the cylinder body.
- (c) Remove the piston from the cylinder body.

NOTICE:

Be careful not to damage the inside of the cylinder body.

- (d) Remove the spring from the cylinder body.
- (e) Remove the bleeder plug cap from the bleeder plug.

5. REMOVE RELEASE CYLINDER BLEEDER PLUG

6. INSTALL RELEASE CYLINDER BLEEDER PLUG

Torque: 8.3 N·m (85 kgf·cm, 73 in.-lbf)

7. INSTALL CLUTCH RELEASE CYLINDER KIT

- (a) Install the bleeder plug cap to the bleeder plug.
- (b) Install a new spring to the cylinder body.

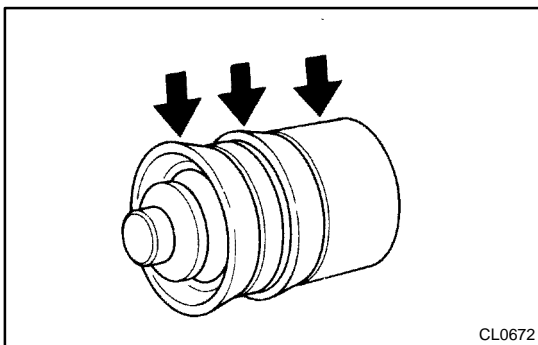

- (c) Coat the piston with lithium soap base glycol grease, as shown in the illustration.
- (d) Install the piston to the cylinder body.

NOTICE:

Be careful not to damage the inside of the cylinder body.

- (e) Install the push rod to the cylinder body.
- (f) Install the boot to the cylinder body.

8. INSTALL CLUTCH RELEASE CYLINDER ASSY

- (a) Install the clutch release cylinder assy with the 2 bolts.
Torque: 12 N·m (120 kgf·cm, 9 ft·lbf)

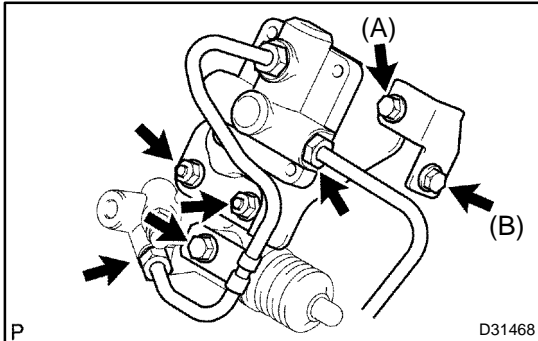
**9. INSTALL CLUTCH ACCUMULATOR ASSY**

- (a) Install the clutch accumulator assy with the 2 nuts and the bolt.

Torque: 12 N·m (120 kgf·cm, 9 ft·lbf)

- (b) Install the flexible hose bracket No.2 with the 2 bolts.

Torque:

Bolt A: 12 N·m (120 kgf·cm, 9 ft·lbf)

Bolt B: 39 N·m (398 kgf·cm, 29 ft·lbf)

10. CONNECT CLUTCH RELEASE CYLINDER TO FLEXIBLE HOSE TUBE

- (a) Using SST, connect the 2 flexible hose tubes.
 SST 09023-00101

Torque: 15 N·m (155 kgf·cm, 11 ft·lbf)

- (b) Install the tube clamp bracket with the bolt.

Torque: 12 N·m (120 kgf·cm, 9 ft·lbf)

11. BLEED CLUTCH PIPE LINE

- (a) Fill the brake reservoir tank with clutch fluid and bleed the clutch system.
Torque: 8.3 N·m (85 kgf·cm, 73 in.-lbf)

12. CHECK CLUTCH FLUID LEAKAGE**13. CHECK FLUID LEVEL IN RESERVOIR**

CLUTCH ACCUMULATOR ASSY (From July, 2003) REPLACEMENT

4207K-02

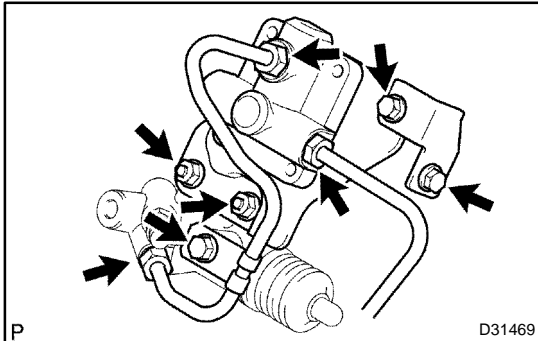

1. DISCONNECT CLUTCH RELEASE CYLINDER TO FLEXIBLE HOSE TUBE

- (a) Remove the bolt and separate the tube clamp bracket.
- (b) Using SST, disconnect the 3 flexible hose tubes.
SST 09023-00101

HINT:

Use a container to catch the fluid.

2. REMOVE CLUTCH ACCUMULATOR ASSY

- (a) Remove the 2 bolts and flexible hose bracket No.2.
- (b) Remove the 2 nuts and clutch accumulator assy.

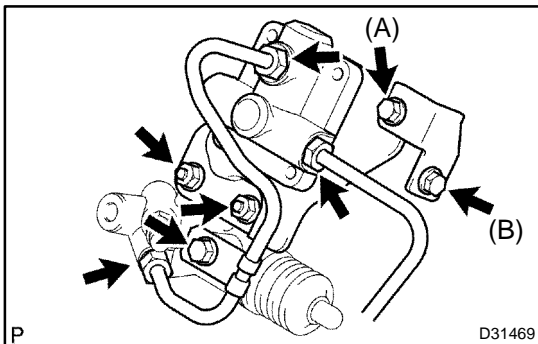

3. INSTALL CLUTCH ACCUMULATOR ASSY

- (a) Install the clutch accumulator assy with the 2 nuts.
Torque: 12 N·m (120 kgf·cm, 9 ft·lbf)
- (b) Install the flexible hose bracket No.2 with the 2 bolts.
Torque:
Bolt A: 12 N·m (120 kgf·cm, 9 ft·lbf)
Bolt B: 39 N·m (398 kgf·cm, 29 ft·lbf)

4. CONNECT CLUTCH RELEASE CYLINDER TO FLEXIBLE HOSE TUBE

- (a) Using SST, connect the 3 flexible hose tubes to the clutch accumulator assy.
SST 09023-00101
Torque: 15 N·m (155 kgf·cm, 11 ft·lbf)
- (b) Install the tube clamp bracket with the bolt.
Torque: 12 N·m (120 kgf·cm, 9 ft·lbf)

5. BLEED CLUTCH PIPE LINE

- (a) Fill the brake reservoir tank with brake fluid and bleed the clutch system.
Torque: 8.3 N·m (85 kgf·cm, 73 ft·lbf)

6. CHECK CLUTCH FLUID LEAKAGE

7. CHECK FLUID LEVEL IN RESERVOIR